

KWVE15-B-S [↗](#)

循环球轴承滑块

滑块 KWVE..-B-S, 窄型滑块, 四列

技术信息

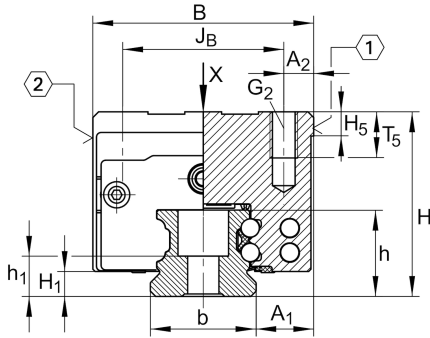

主要尺寸和性能数据

H	24 mm	height system
B	34 mm	width carriage
L	61.2 mm	overall length carriage
C	7,200 N	dynamic load rating
C ₀	14,500 N	static load rating
M _{0x}	150 Nm	static moment rating about X axis
M _{0y}	100 Nm	static moment rating about Y axis
M _{0z}	100 Nm	static moment rating about Z axis
≈m	0.16 kg	重量

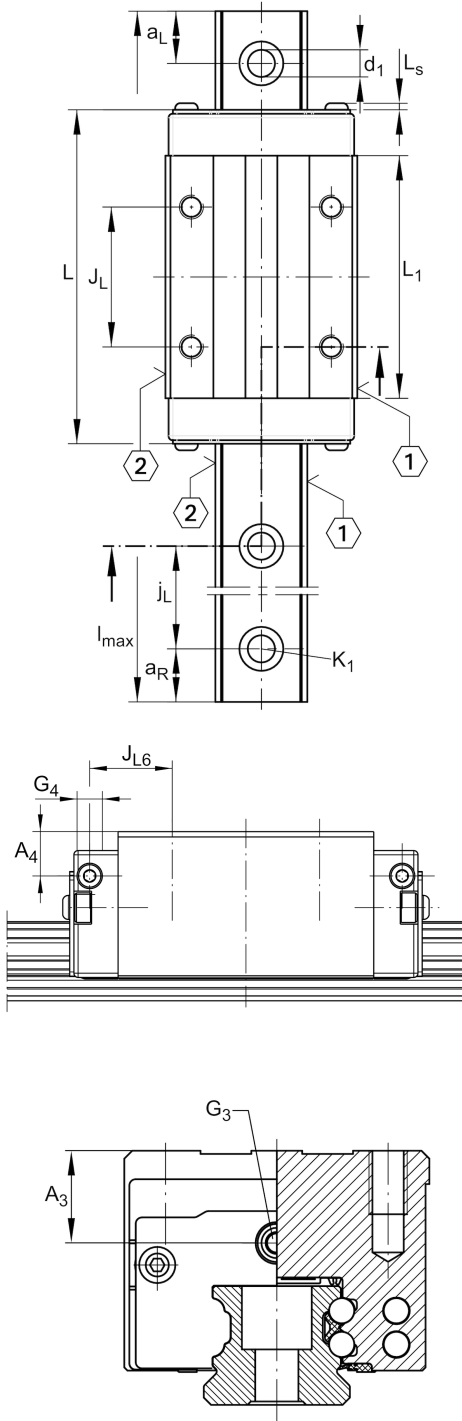

安装尺寸

A_1	9.5 mm	Distance from locating edge on carriage to locating edge on guideway
J_B	26 mm	
b	15 mm	width rail
A_2	4 mm	Distance from locating edge to hole
L_1	39.8 mm	
L_s	1.3 mm	
J_L	26 mm	
H_1	4.3 mm	Free space, system dimension
H_5	4.75 mm	
T_5	6 mm	Thread depth
G_2	M4	fixing screws above (DIN ISO 4762-12.9)
$G_2 M_A$	5 Nm	maximum tightening torque
A_3	4.3 mm	position lubrication connector
G_3	M3	lubrication connector
$t G_3$	5.5 mm	maximum permissible screw depth for lubrication connectors
A_4	3.2 mm	position lubrication connector
G_4	M3	lubrication connector
$t G_4$	5.5 mm	maximum permissible screw depth for lubrication connectors
J_{L6}	11.1 mm	position lubrication connector

附加信息

VMKB_065	KWVE	Material name
----------	------	---------------

