

## RWU65-F-HL [↗](#)

### 循环滚子轴承滑块

带满装循环滚珠导引系统的标准滑块, 用于直线循环滚珠轴承和导轨组件, 用于油润滑或脂润滑

## 技术信息

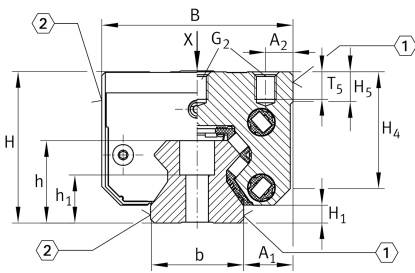

### 主要尺寸和性能数据

|                 |           |                                   |
|-----------------|-----------|-----------------------------------|
| H               | 100 mm    | height system                     |
| B               | 126 mm    | width carriage                    |
| L               | 261.9 mm  | overall length carriage           |
| C               | 270,000 N | dynamic load rating               |
| C <sub>0</sub>  | 640,000 N | dynamic load rating               |
| M <sub>0x</sub> | 7,600 Nm  | static moment rating about X axis |
| M <sub>0y</sub> | 24,000 Nm | static moment rating about Y axis |
| M <sub>0z</sub> | 21,500 Nm | static moment rating about Z axis |
| ≈m              | 12.89 kg  | 重量                                |



安装尺寸

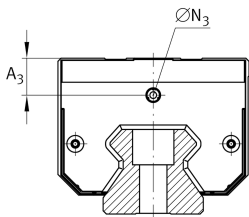
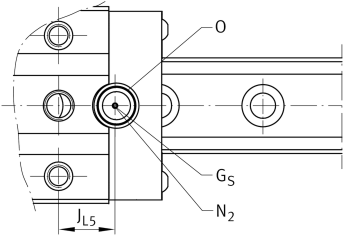
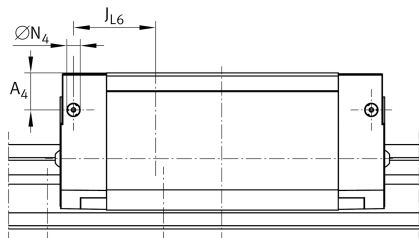
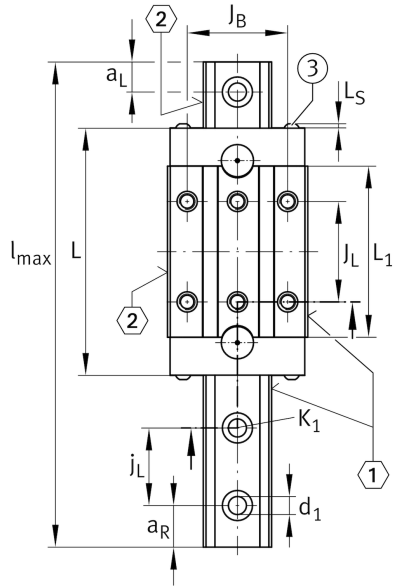

|           |          |  |
|-----------|----------|--|
| $A_1$     | 31.5 mm  | Distance from locating edge on carriage to locating edge on guideway |
| $J_B$     | 76 mm    |  |
| $b$       | 63 mm    | width rail   |
| $A_2$     | 25 mm    | Distance from locating edge to hole                                  |
| $L_1$     | 207.6 mm |  |
| $L_S$     | 2.75 mm  |  |
| $J_L$     | 120 mm   |  |
| $H_1$     | 11.5 mm  | Free space, system dimension   |
| $H_4$     | 71.2 mm  |  |
| $H_5$     | 15 mm    |  |
| $T_5$     | 20 mm    | Thread depth   |
| $G_2$     | M14      | fixing screws below (DIN ISO 4762-12.9)                              |
| $G_2 M_A$ | 220 Nm   | maximum tightening torque  |
| $A_3$     | 29.6 mm  | position lubrication connector                                       |
| $N_3$     | M6       | lubrication connector  |
| $t N_3$   | 6 mm     | maximum permissible screw depth for lubrication connectors           |
| $A_4$     | 29.6 mm  | position lubrication connector                                       |
| $N_4$     | 6 mm     | lubrication connector  |
| $t N_4$   | 6 mm     | maximum permissible screw depth for lubrication connectors           |
| $J_{L6}$  | 63.1 mm  | position lubrication connector                                       |
| $N_2$     | 6 mm     | max. diameter of lubrication hole in adjacent construction           |
| $J_{L5}$  | 43.8 mm  | position lubrication connector                                       |
| $G_S$     | M4x4     |  |
| $O$       | 18x1,5   | O-Ring DIN 3771  |

