**PR14135**

直线循环滚柱轴承组件

直线滚珠轴承，英制安装尺寸，PR

技术信息

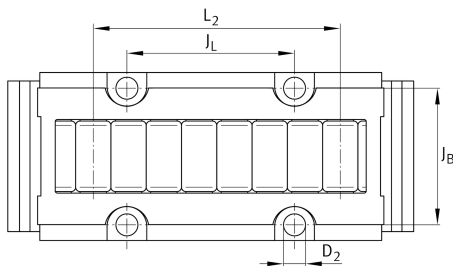
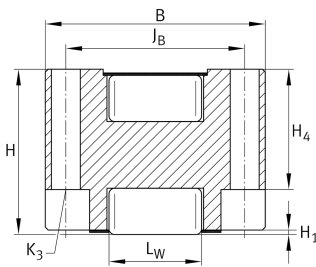
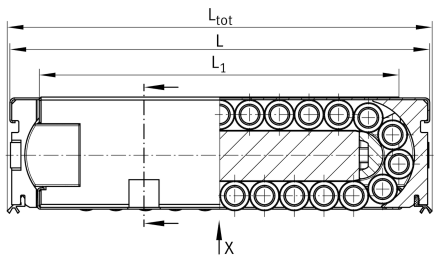

主要尺寸和性能数据

L	198 mm	
B	76.2 mm	宽度
H	57.2 mm	高度
C	435,000 N	Load capacity Dynamic
C ₀	735,000 N	Load capacity static
≈m	5.74 kg	重量

安装尺寸

L ₁	158 mm	
J _B	62 mm	Mounting Dimension
Tol J _B	±0,1	Tolerance
J _L	76.2 mm	Mounting Dimension
Tol J _L	±0,1	Tolerance
H ₁	0.1 mm	
L ₂	126 mm	
L _W	30 mm	
H ₄	42 mm	
K ₃	M6	Size thread K3
K3 M _A	17 Nm	Tightening Torque fixing screws
D ₂	7 mm	

Related products

UG16260, UGN16260- suitable Guide Rail
A, UZ16260,
UZN16260-A,
UFK8815, UFB10615