**PR14182**

直线循环滚柱轴承组件

直线滚珠轴承，英制安装尺寸，PR

技术信息

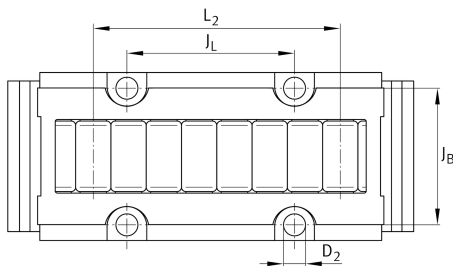
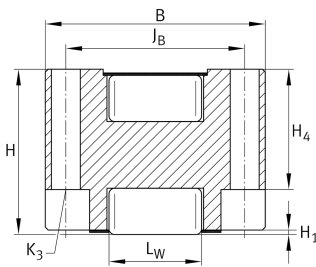
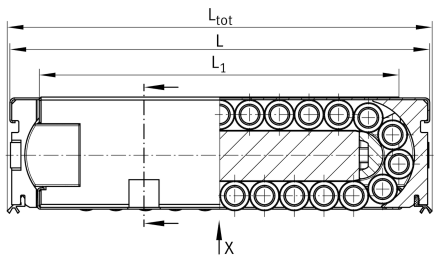

主要尺寸和性能数据

L	264 mm	
B	101.6 mm	宽度
H	76.2 mm	高度
C	790,000 N	Load capacity Dynamic
C ₀	1,325,000 N	Load capacity static
≈m	13.25 kg	重量

安装尺寸

L ₁	211 mm	
J _B	82.5 mm	Mounting Dimension
Tol J _B	±0,1	Tolerance
J _L	101.6 mm	Mounting Dimension
Tol J _L	±0,1	Tolerance
H ₁	0.1 mm	
L ₂	167 mm	
L _W	40 mm	
H ₄	56.3 mm	
K ₃	M8	Size thread K3
K3 M _A	41 Nm	Tightening Torque fixing screws
D ₂	9 mm	

Related products

UFK11518, UFB14018 suitable Guide Rail