**PR14089** [🔗](#)

直线循环滚柱轴承组件

直线滚珠轴承，英制安装尺寸，PR

技术信息

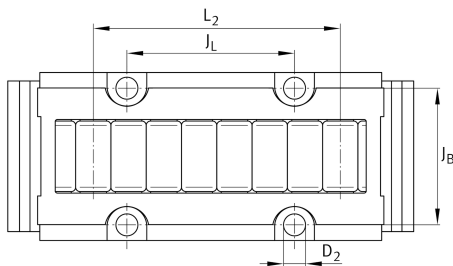
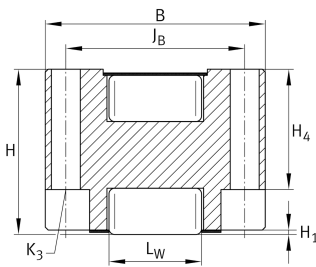
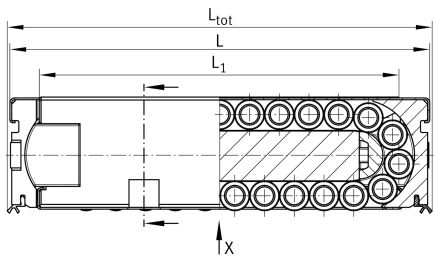

主要尺寸和性能数据

L	142 mm	
B	50.8 mm	宽度
H	38.1 mm	高度
C	205,000 N	Load capacity Dynamic
C ₀	354,000 N	Load capacity static
≈m	1.75 kg	重量

安装尺寸

L ₁	121.5 mm	
J _B	41 mm	Mounting Dimension
Tol J _B	±0,1	Tolerance
J _L	51 mm	Mounting Dimension
Tol J _L	±0,1	Tolerance
H ₁	0.1 mm	
L ₂	90 mm	
L _W	20 mm	
H ₄	27.7 mm	
K ₃	M5	Size thread K3
K3 M _A	10 Nm	Tightening Torque fixing screws
D ₂	6 mm	

Related products

VUSZ24084-A	Adjustment gib
UG12553, UGN12553-A, UZ12553, UZN12553-A, UFK8815, UFB10615	suitable Guide Rail