**TKVD25-W**

修形轨道

四列直线循环滚珠轴承及导轨组件KUVE的导轨.-W, 宽导轨

技术信息

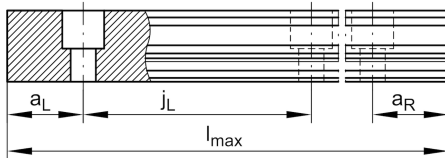
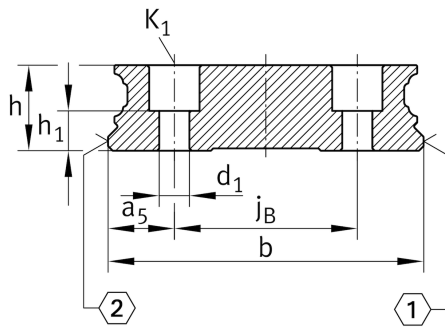

主要尺寸和性能数据

h	18.7 mm	Height
b	69 mm	Width
Tol b	-0.005 mm	Upper tolerance
Tol b	-0.035 mm	Lower tolerance
≈m	9.4 kg/m	重量

安装尺寸

K ₁	M6	Thread
K1 M _A	17 Nm	Tightening torque
d ₁	6.8 mm	Bore diameter

尺寸

l _{max}	6,000 mm	Max length single piece guideway
a _{L max}	71 mm	Distance
a _{L min}	20 mm	Distance
a _{R max}	71 mm	Distance
a _{R min}	20 mm	Distance
j _L	80 mm	Increment
j _B	40 mm	Increment
a ₅	14.5 mm	Distance
h ₁	8.2 mm	length
Tol h ₁	0.5 mm	Upper tolerance
Tol h ₁	-0.5 mm	Distance Distance

附加信息

KWVE25-W...	usable carriage(s)
KUVE25-W...	usable linear systems