**TKVD30-W**

## 修形轨道

四列直线循环滚珠轴承及导轨组件KUVE的导轨.-W, 宽导轨

## 技术信息

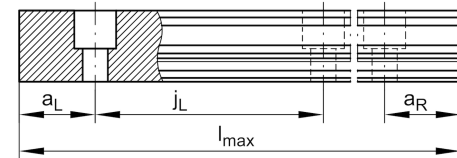
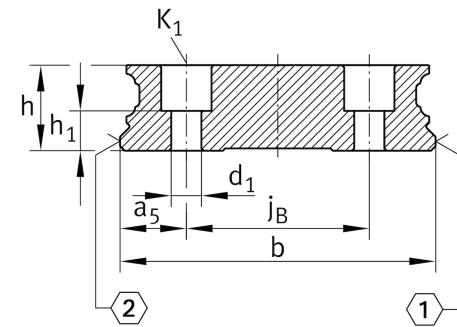

## 主要尺寸和性能数据

h	23.5 mm	Height
b	80 mm	Width
Tol b	-0.005 mm	Upper tolerance
Tol b	-0.035 mm	Lower tolerance
≈m	13.6 kg/m	重量

## 安装尺寸

K <sub>1</sub>	M8	Thread
K1 M <sub>A</sub>	41 Nm	Tightening torque
d <sub>1</sub>	9 mm	Bore diameter

## 尺寸

l <sub>max</sub>	6,000 mm	Max length single piece guideway
a <sub>L max</sub>	71 mm	Distance
a <sub>L min</sub>	20 mm	Distance
a <sub>R max</sub>	71 mm	Distance
a <sub>R min</sub>	20 mm	Distance
j <sub>L</sub>	80 mm	Increment
j <sub>B</sub>	50 mm	Increment
a <sub>5</sub>	15 mm	Distance
h <sub>1</sub>	11 mm	length
Tol h <sub>1</sub>	0.5 mm	Upper tolerance
Tol h <sub>1</sub>	-0.5 mm	Distance Distance

## 附加信息

KWVE30-W...	usable carriage(s)
KUVE30-W...	usable linear systems